

M3 Junction 9 Improvement

Scheme Number: TR010055

2.3 Work Plans (Rev 1)

APFP Regulations 5(2)(j)

Planning Act 2008

**Infrastructure Planning (Applications: Prescribed Forms and
Procedure) Regulations 2009**

Volume 2

15 June 2023



NOTES
 Purpose of use
APPLICATION SUBMISSION
 Development Consent Order Number / Document
 TR010055/2.3

1. THIS DRAWING HAS BEEN PRODUCED USING CAD SOFTWARE. THEREFORE ALL DIMENSIONS ARE SHOWN IN METRES UNLESS SHOWN OTHERWISE.
 2. DO NOT SCALE FROM THIS DRAWING. USE ONLY PRINTED DIMENSIONS.

KEY TO SYMBOLS
 DEVELOPMENT CONSENT ORDER BOUNDARY

REV	DATE	REVISION NOTE	ORIG	CHK'D	APP'D
0	NOVEMBER 2022	APPLICATION SUBMISSION	GP	LC	MF

DESIGNER

CONTRACTOR

CLIENT

PROJECT TITLE
 M3 JUNCTION 9 IMPROVEMENT SCHEME

PROJECT STAGE
 PCF STAGE 3

DRAWING TITLE
 WORKS PLANS
 APFP REGULATION 5(2)(j)
 KEY PLAN
 DOCUMENT REFERENCE: 2.3

SUITABILITY
 APPLICATION SUBMISSION

SHEET SIZE: A1 SCALE: 1:12,500 STATUS: REV 0
 DRAWING NUMBER
 HES51511-VFK-LSI-X_XXXX_XX-DR-ZL-1000

© Crown copyright and database rights 2022. Use of this data is subject to terms and conditions. Ordnance Survey Licence 100030649.

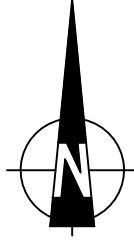

BASINGSTOKE

M3

PRIVATE FARM TRACK

PRIVATE FARM TRACK

FOR CONTINUATION SEE SHEET 2 OF 10

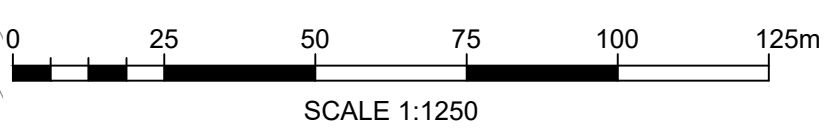

NOTES

Purpose of use
APPLICATION SUBMISSION

Development Consent Order Number / Document
TR010055/2.3

- THIS DRAWING HAS BEEN PRODUCED USING CAD SOFTWARE. THEREFORE ALL DIMENSIONS ARE SHOWN IN METRES UNLESS SHOWN OTHERWISE.
- DO NOT SCALE FROM THIS DRAWING. USE ONLY PRINTED DIMENSIONS.
- THE DESIGN SHOWN WILL BE SUBJECT TO DETAILED DESIGN DEVELOPMENT IN ACCORDANCE WITH THE PROVISIONS OF THE DEVELOPMENT CONSENT ORDER.

KEY TO SYMBOLS

- DEVELOPMENT CONSENT ORDER BOUNDARY
- LAND NOT INCLUDED IN ORDER LIMITS
- HIGHWAY WORK LIMIT OF DEVIATION (AS DETAILED IN PART 2 OF THE DEVELOPMENT CONSENT ORDER)
- LIMITS OF DEVIATION LABEL (AS DETAILED IN PART 2 OF THE DEVELOPMENT CONSENT ORDER)
- WORK NUMBER (AS DETAILED IN SCHEDULE 1 OF THE DEVELOPMENT CONSENT ORDER)
- COMMENCEMENT OF LINEAR WORKS
- TERMINATION OF LINEAR WORKS
- COMMENCEMENT AND TERMINATION OF LINEAR WORKS
- PROPOSED HIGHWAY WORK CENTRE LINE (APPROX)
- PROPOSED EARTHWORKS OUTLINE (INCLUDING LATERAL DEVIATION)
- PROPOSED ROAD MARKINGS
- PROPOSED CONSTRUCTION COMPOUND
- PROPOSED UTILITY DIVERSION CENTRELINE
- PROPOSED UTILITY DIVERSION LIMIT OF DEVIATION
- PROPOSED SURFACE WATER DRAINAGE DITCH
- PROPOSED SURFACE WATER ATTENUATION BASIN
- PROPOSED SURFACE WATER ATTENUATION BASIN
- MAINTENANCE ACCESS TRACK
- PROPOSED SURFACE WATER DRAINAGE OUTFALL
- PROPOSED RETAINING WALL
- PROPOSED VARIABLE MESSAGE SIGN
- PROPOSED GANTRY
- PROPOSED TRAFFIC SIGN(S) (ANCILLARY WORKS)
- PROPOSED EMERGENCY ROADSIDE TELEPHONE
- PROPOSED SPLITTER ISLAND

REV	DATE	REVISION NOTE	ORIG	CHKD	APPD
01	JUNE 2023	DEADLINE 2	EO	LC	MF
0	NOVEMBER 2022	APPLICATION SUBMISSION	GP	LC	MF

REFERENCE MAP

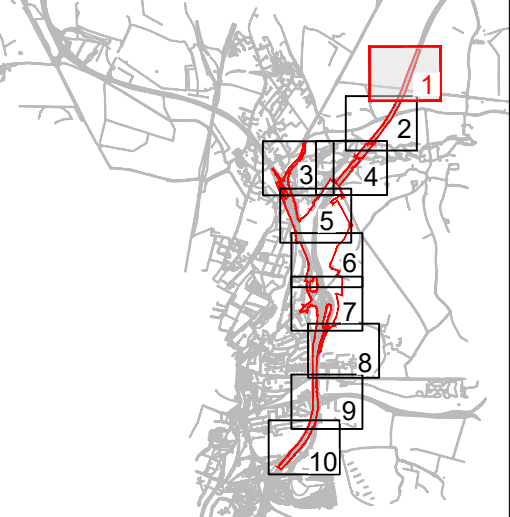

DESIGNER

CONTRACTOR

CLIENT

PROJECT TITLE
M3 JUNCTION 9 IMPROVEMENT SCHEME

PROJECT STAGE
PCF STAGE 3

DRAWING TITLE
WORKS PLANS
APFP REGULATION 5(2)(j)
SHEET 1 OF 10
DOCUMENT REFERENCE: 2.3

SUITABILITY
APPLICATION SUBMISSION

SHEET SIZE: A1 SCALE: 1:1250 STATUS: REV 01
DRAWING NUMBER
HES51511-VFK-LSI-X_XXXX_XX-DR-ZL-1001

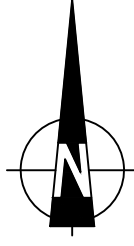

FOR CONTINUATION SEE SHEET 1 OF 10

ABBOTS WORTHY

B3047

M3

B3047

B3047

RIVER ITCHEN

RIVER ITCHEN

FOR CONTINUATION SEE SHEET 4 OF 10

WORK NO. 46

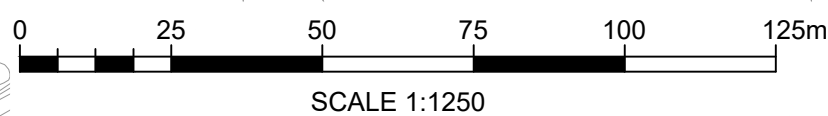

NOTES

Purpose of use
APPLICATION SUBMISSION

Development Consent Order Number / Document
TR010055/2.3

- THIS DRAWING HAS BEEN PRODUCED USING CAD SOFTWARE. THEREFORE ALL DIMENSIONS ARE SHOWN IN METRES UNLESS SHOWN OTHERWISE.
- DO NOT SCALE FROM THIS DRAWING. USE ONLY PRINTED DIMENSIONS.
- THE DESIGN SHOWN WILL BE SUBJECT TO DETAILED DESIGN DEVELOPMENT IN ACCORDANCE WITH THE PROVISIONS OF THE DEVELOPMENT CONSENT ORDER.

- KEY TO SYMBOLS
- DEVELOPMENT CONSENT ORDER BOUNDARY
 - LAND NOT INCLUDED IN ORDER LIMITS
 - HIGHWAY WORK LIMIT OF DEVIATION (AS DETAILED IN PART 2 OF THE DEVELOPMENT CONSENT ORDER)
 - LIMITS OF DEVIATION LABEL (AS DETAILED IN PART 2 OF THE DEVELOPMENT CONSENT ORDER)
 - WORK NUMBER (AS DETAILED IN SCHEDULE 1 OF THE DEVELOPMENT CONSENT ORDER)
 - COMMENCEMENT OF LINEAR WORKS
 - TERMINATION OF LINEAR WORKS
 - COMMENCEMENT AND TERMINATION OF LINEAR WORKS
 - PROPOSED HIGHWAY WORK CENTRE LINE (APPROX)
 - PROPOSED EARTHWORKS OUTLINE (INCLUDING LATERAL DEVIATION)
 - PROPOSED ROAD MARKINGS
 - PROPOSED CONSTRUCTION COMPOUND
 - PROPOSED UTILITY DIVERSION CENTRELINE
 - PROPOSED UTILITY DIVERSION LIMIT OF DEVIATION
 - PROPOSED SURFACE WATER DRAINAGE DITCH
 - PROPOSED SURFACE WATER ATTENUATION BASIN
 - PROPOSED SURFACE WATER ATTENUATION BASIN
 - MAINTENANCE ACCESS TRACK
 - PROPOSED SURFACE WATER DRAINAGE OUTFALL
 - PROPOSED RETAINING WALL
 - PROPOSED VARIABLE MESSAGE SIGN
 - PROPOSED GANTRY
 - PROPOSED TRAFFIC SIGN(S) (ANCILLARY WORKS)
 - PROPOSED EMERGENCY ROADSIDE TELEPHONE
 - PROPOSED SPLITTER ISLAND

REV	DATE	REVISION NOTE	ORIG	CHKD	APPD
01	JUNE 2023	DEADLINE 2	EO	LC	MF
0	NOVEMBER 2022	APPLICATION SUBMISSION	GP	LC	MF

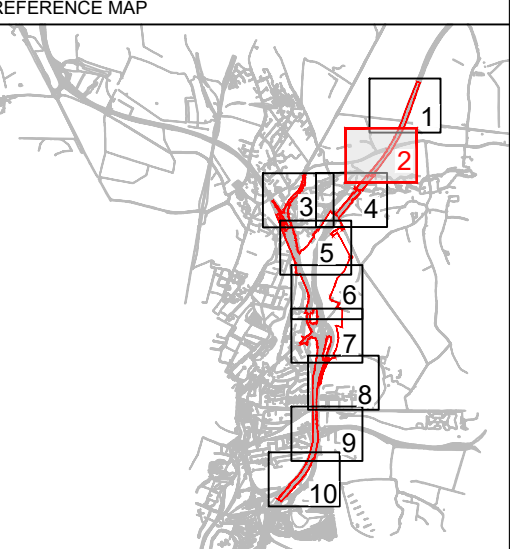

DESIGNER

CONTRACTOR

CLIENT

PROJECT TITLE
M3 JUNCTION 9 IMPROVEMENT SCHEME

PROJECT STAGE
PCF STAGE 3

DRAWING TITLE
**WORKS PLANS
APFP REGULATION 5(2)(j)
SHEET 2 OF 10
DOCUMENT REFERENCE: 2.3**

SUITABILITY
APPLICATION SUBMISSION

SHEET SIZE: A1 SCALE: 1:1250 STATUS: REV 01
DRAWING NUMBER
HES51511-VFK-LSI-X_XXXX_XX-DR-ZL-1002

© Crown copyright and database rights 2022. Use of this data is subject to terms and conditions. Ordnance Survey Licence 100030649.

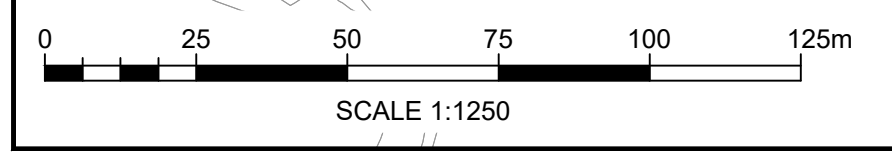
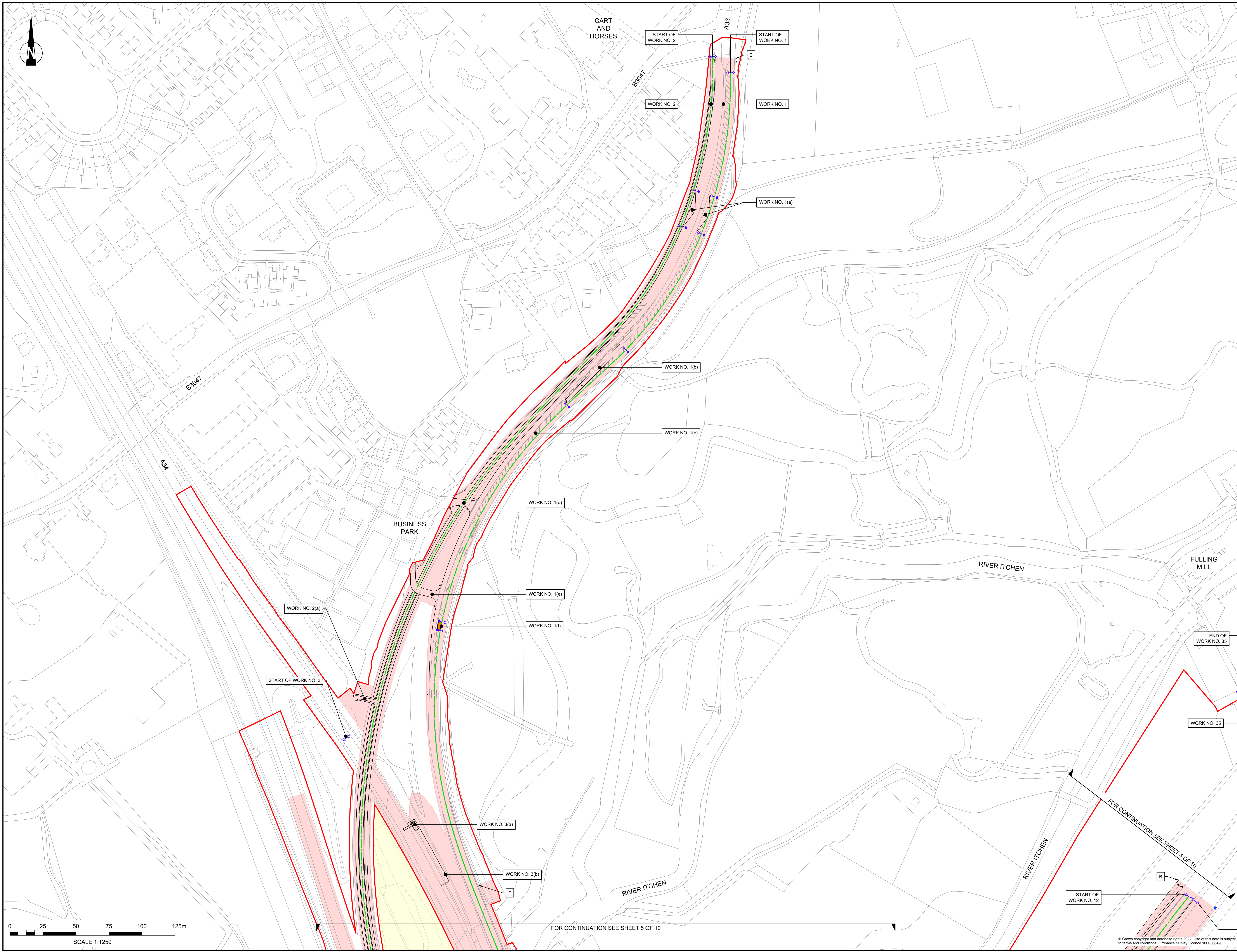

NOTES
 Purpose of use
APPLICATION SUBMISSION
 Development Consent Order Number / Document
TR010055/2.3

- THIS DRAWING HAS BEEN PRODUCED USING CAD SOFTWARE. THEREFORE ALL DIMENSIONS ARE SHOWN IN METRES UNLESS SHOWN OTHERWISE.
- DO NOT SCALE FROM THIS DRAWING. USE ONLY PRINTED DIMENSIONS.
- THE DESIGN SHOWN WILL BE SUBJECT TO DETAILED DESIGN DEVELOPMENT IN ACCORDANCE WITH THE PROVISIONS OF THE DEVELOPMENT CONSENT ORDER.

- KEY TO SYMBOLS
- DEVELOPMENT CONSENT ORDER BOUNDARY
 - LAND NOT INCLUDED IN ORDER LIMITS
 - HIGHWAY WORK LIMIT OF DEVIATION (AS DETAILED IN PART 2 OF THE DEVELOPMENT CONSENT ORDER)
 - A LIMITS OF DEVIATION LABEL (AS DETAILED IN PART 2 OF THE DEVELOPMENT CONSENT ORDER)
 - WORK NO. XX WORK NUMBER (AS DETAILED IN SCHEDULE 1 OF THE DEVELOPMENT CONSENT ORDER)
 - COMMENCEMENT OF LINEAR WORKS
 - TERMINATION OF LINEAR WORKS
 - COMMENCEMENT AND TERMINATION OF LINEAR WORKS
 - - - PROPOSED HIGHWAY WORK CENTRE LINE (APPROX)
 - - - PROPOSED EARTHWORKS OUTLINE (INCLUDING LATERAL DEVIATION)
 - PROPOSED ROAD MARKINGS
 - PROPOSED CONSTRUCTION COMPOUND
 - PROPOSED UTILITY DIVERSION CENTRELINE
 - PROPOSED UTILITY DIVERSION LIMIT OF DEVIATION
 - PROPOSED SURFACE WATER DRAINAGE DITCH
 - PROPOSED SURFACE WATER ATTENUATION BASIN
 - PROPOSED SURFACE WATER ATTENUATION BASIN MAINTENANCE ACCESS TRACK
 - V PROPOSED SURFACE WATER DRAINAGE OUTFALL
 - PROPOSED RETAINING WALL
 - PROPOSED VARIABLE MESSAGE SIGN
 - PROPOSED GANTRY
 - PROPOSED TRAFFIC SIGN(S) (ANCILLARY WORKS)
 - PROPOSED EMERGENCY ROADSIDE TELEPHONE
 - PROPOSED SPLITTER ISLAND

REV	DATE	REVISION NOTE	ORIG	CHKD	APPD
01	JUNE 2023	DEADLINE 2	EO	LC	MF
0	NOVEMBER 2022	APPLICATION SUBMISSION	GP	LC	MF

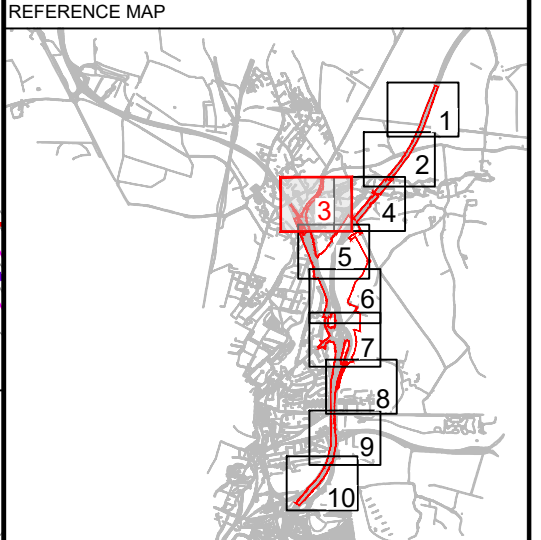

DESIGNER

CONTRACTOR

CLIENT

PROJECT TITLE
M3 JUNCTION 9 IMPROVEMENT SCHEME

PROJECT STAGE
PCF STAGE 3

DRAWING TITLE
**WORKS PLANS
 APFP REGULATION 5(2)(j)
 SHEET 3 OF 10
 DOCUMENT REFERENCE: 2.3**

SUITABILITY
APPLICATION SUBMISSION

SHEET SIZE: A1 SCALE: 1:1,250 STATUS: REV 01
 DRAWING NUMBER
 HES51511-VFK-LSI-X_XXXX_XX-DR-ZL-1003

FOR CONTINUATION SEE SHEET 5 OF 10

FOR CONTINUATION SEE SHEET 4 OF 10

© Crown copyright and database rights 2022. Use of this data is subject to terms and conditions. Ordnance Survey Licence 100030649.

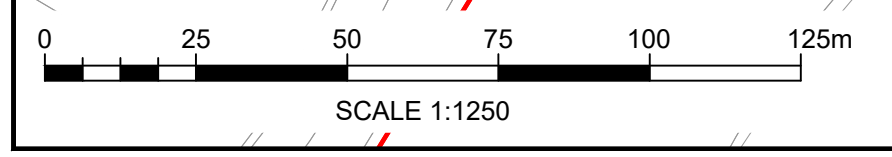
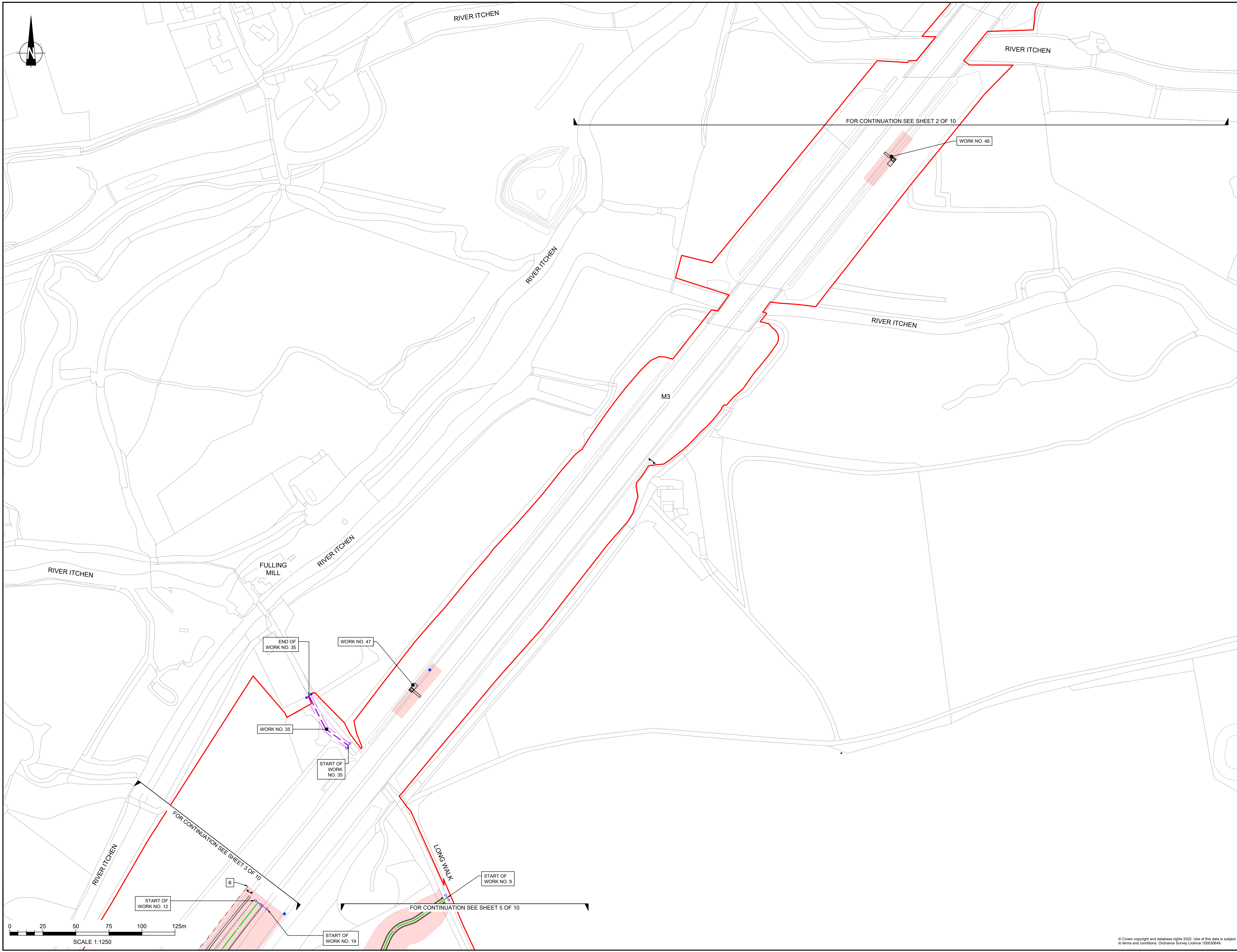

NOTES

Purpose of use
APPLICATION SUBMISSION
 Development Consent Order Number / Document
TR010055/2.3

- THIS DRAWING HAS BEEN PRODUCED USING CAD SOFTWARE. THEREFORE ALL DIMENSIONS ARE SHOWN IN METRES UNLESS SHOWN OTHERWISE.
- DO NOT SCALE FROM THIS DRAWING. USE ONLY PRINTED DIMENSIONS.
- THE DESIGN SHOWN WILL BE SUBJECT TO DETAILED DESIGN DEVELOPMENT IN ACCORDANCE WITH THE PROVISIONS OF THE DEVELOPMENT CONSENT ORDER.

KEY TO SYMBOLS

- DEVELOPMENT CONSENT ORDER BOUNDARY
- LAND NOT INCLUDED IN ORDER LIMITS
- HIGHWAY WORK LIMIT OF DEVIATION (AS DETAILED IN PART 2 OF THE DEVELOPMENT CONSENT ORDER)
- LIMITS OF DEVIATION LABEL (AS DETAILED IN PART 2 OF THE DEVELOPMENT CONSENT ORDER)
- WORK NUMBER (AS DETAILED IN SCHEDULE 1 OF THE DEVELOPMENT CONSENT ORDER)
- COMMENCEMENT OF LINEAR WORKS
- TERMINATION OF LINEAR WORKS
- COMMENCEMENT AND TERMINATION OF LINEAR WORKS
- PROPOSED HIGHWAY WORK CENTRE LINE (APPROX)
- PROPOSED EARTHWORKS OUTLINE (INCLUDING LATERAL DEVIATION)
- PROPOSED ROAD MARKINGS
- PROPOSED CONSTRUCTION COMPOUND
- PROPOSED UTILITY DIVERSION CENTRELINE
- PROPOSED UTILITY DIVERSION LIMIT OF DEVIATION
- PROPOSED SURFACE WATER DRAINAGE DITCH
- PROPOSED SURFACE WATER ATTENUATION BASIN
- PROPOSED SURFACE WATER ATTENUATION BASIN MAINTENANCE ACCESS TRACK
- PROPOSED SURFACE WATER DRAINAGE OUTFALL
- PROPOSED RETAINING WALL
- PROPOSED VARIABLE MESSAGE SIGN
- PROPOSED GANTRY
- PROPOSED TRAFFIC SIGN(S) (ANCILLARY WORKS)
- PROPOSED EMERGENCY ROADSIDE TELEPHONE
- PROPOSED SPLITTER ISLAND

01	JUNE 2023	DEADLINE 2	EO	LC	MF
0	NOVEMBER 2022	APPLICATION SUBMISSION	GP	LC	MF
REV	DATE	REVISION NOTE	ORIG	CHKD	APPD

REFERENCE MAP

DESIGNER

CONTRACTOR

CLIENT

PROJECT TITLE
 M3 JUNCTION 9 IMPROVEMENT SCHEME

PROJECT STAGE
 PCF STAGE 3

DRAWING TITLE
 WORKS PLANS
 APFP REGULATION 5(2)(j)
 SHEET 4 OF 10
 DOCUMENT REFERENCE: 2.3

SUITABILITY
 APPLICATION SUBMISSION

SHEET SIZE: A1 SCALE: 1:1250 STATUS: REV 01
 DRAWING NUMBER
 HES51511-VFK-LSI-X_XXXX_XX-DR-ZL-1004

© Crown copyright and database rights 2022. Use of this data is subject to terms and conditions. Ordnance Survey Licence 100030649.

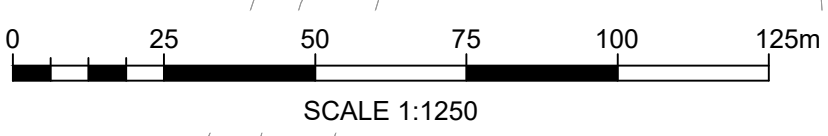
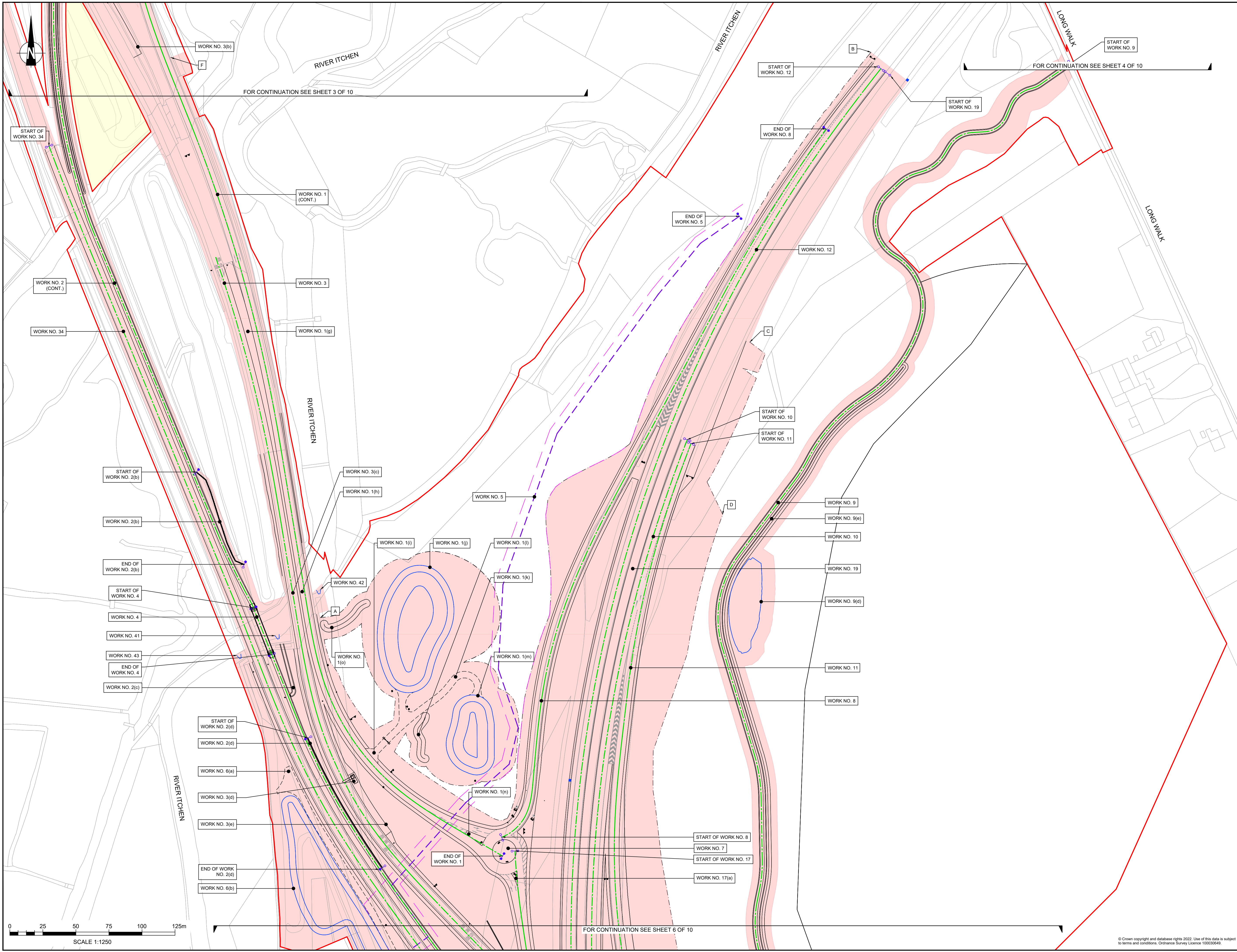

NOTES

Purpose of use
APPLICATION SUBMISSION
 Development Consent Order Number / Document
TR010055/2.3

- THIS DRAWING HAS BEEN PRODUCED USING CAD SOFTWARE. THEREFORE ALL DIMENSIONS ARE SHOWN IN METRES UNLESS SHOWN OTHERWISE.
- DO NOT SCALE FROM THIS DRAWING. USE ONLY PRINTED DIMENSIONS.
- THE DESIGN SHOWN WILL BE SUBJECT TO DETAILED DESIGN DEVELOPMENT IN ACCORDANCE WITH THE PROVISIONS OF THE DEVELOPMENT CONSENT ORDER.

KEY TO SYMBOLS

- DEVELOPMENT CONSENT ORDER BOUNDARY
- LAND NOT INCLUDED IN ORDER LIMITS
- HIGHWAY WORK LIMIT OF DEVIATION (AS DETAILED IN PART 2 OF THE DEVELOPMENT CONSENT ORDER)
- LIMITS OF DEVIATION LABEL (AS DETAILED IN PART 2 OF THE DEVELOPMENT CONSENT ORDER)
- WORK NUMBER (AS DETAILED IN SCHEDULE 1 OF THE DEVELOPMENT CONSENT ORDER)
- COMMENCEMENT OF LINEAR WORKS
- TERMINATION OF LINEAR WORKS
- COMMENCEMENT AND TERMINATION OF LINEAR WORKS
- PROPOSED HIGHWAY WORK CENTRE LINE (APPROX)
- PROPOSED EARTHWORKS OUTLINE (INCLUDING LATERAL DEVIATION)
- PROPOSED ROAD MARKINGS
- PROPOSED CONSTRUCTION COMPOUND
- PROPOSED UTILITY DIVERSION CENTRELINE
- PROPOSED UTILITY DIVERSION LIMIT OF DEVIATION
- PROPOSED SURFACE WATER DRAINAGE DITCH
- PROPOSED SURFACE WATER ATTENUATION BASIN
- PROPOSED SURFACE WATER ATTENUATION BASIN MAINTENANCE ACCESS TRACK
- PROPOSED SURFACE WATER DRAINAGE OUTFALL
- PROPOSED RETAINING WALL
- PROPOSED VARIABLE MESSAGE SIGN
- PROPOSED GANTRY
- PROPOSED TRAFFIC SIGN(S) (ANCILLARY WORKS)
- PROPOSED EMERGENCY ROADSIDE TELEPHONE
- PROPOSED SPLITTER ISLAND

REV	DATE	REVISION NOTE	ORIG	CHKD	APPD
01	JUNE 2023	DEADLINE 2	EO	LC	MF
0	NOVEMBER 2022	APPLICATION SUBMISSION	GP	LC	MF

REFERENCE MAP

DESIGNER
Stantec

CONTRACTOR
VolkerFitzpatrick

CLIENT
national highways

PROJECT TITLE
M3 JUNCTION 9 IMPROVEMENT SCHEME

PROJECT STAGE
PCF STAGE 3

DRAWING TITLE
**WORKS PLANS
 APFP REGULATION 5(2)(j)
 SHEET 5 OF 10
 DOCUMENT REFERENCE: 2.3**

SUITABILITY
APPLICATION SUBMISSION

SHEET SIZE: A1 SCALE: 1:1250 STATUS: REV 01
 DRAWING NUMBER
 HES51511-VFK-LSI-X_XXXX_XX-DR-ZL-1005

© Crown copyright and database rights 2022. Use of this data is subject to terms and conditions. Ordnance Survey Licence 100030649

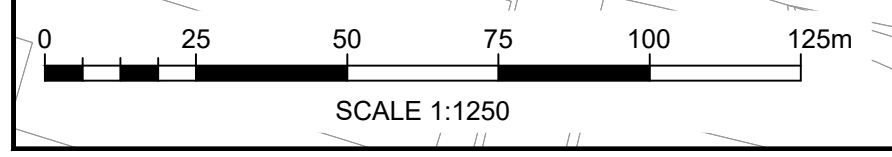
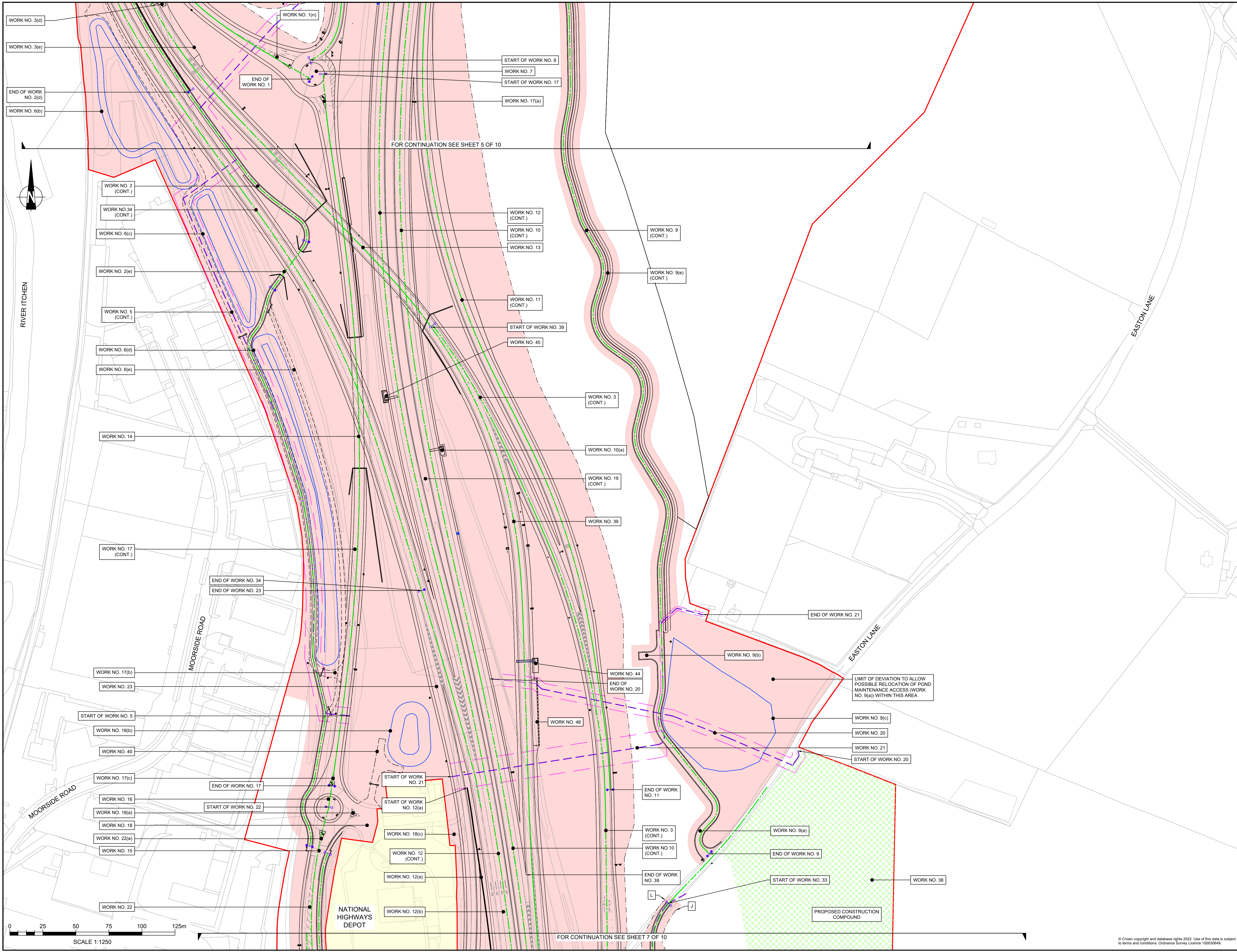

NOTES

Purpose of use
APPLICATION SUBMISSION
 Development Consent Order Number / Document
 TR010055/2.3

- THIS DRAWING HAS BEEN PRODUCED USING CAD SOFTWARE. THEREFORE ALL DIMENSIONS ARE SHOWN IN METRES UNLESS SHOWN OTHERWISE.
- DO NOT SCALE FROM THIS DRAWING. USE ONLY PRINTED DIMENSIONS.
- THE DESIGN SHOWN WILL BE SUBJECT TO DETAILED DESIGN DEVELOPMENT IN ACCORDANCE WITH THE PROVISIONS OF THE DEVELOPMENT CONSENT ORDER.

KEY TO SYMBOLS

- DEVELOPMENT CONSENT ORDER BOUNDARY
- LAND NOT INCLUDED IN ORDER LIMITS
- HIGHWAY WORK LIMIT OF DEVIATION (AS DETAILED IN PART 2 OF THE DEVELOPMENT CONSENT ORDER)
- LIMITS OF DEVIATION LABEL (AS DETAILED IN PART 2 OF THE DEVELOPMENT CONSENT ORDER)
- WORK NUMBER (AS DETAILED IN SCHEDULE 1 OF THE DEVELOPMENT CONSENT ORDER)
- COMMENCEMENT OF LINEAR WORKS
- TERMINATION OF LINEAR WORKS
- COMMENCEMENT AND TERMINATION OF LINEAR WORKS
- PROPOSED HIGHWAY WORK CENTRE LINE (APPROX)
- PROPOSED EARTHWORKS OUTLINE (INCLUDING LATERAL DEVIATION)
- PROPOSED ROAD MARKINGS
- PROPOSED CONSTRUCTION COMPOUND
- PROPOSED UTILITY DIVERSION CENTRELINE
- PROPOSED UTILITY DIVERSION LIMIT OF DEVIATION
- PROPOSED SURFACE WATER DRAINAGE DITCH
- PROPOSED SURFACE WATER ATTENUATION BASIN
- PROPOSED SURFACE WATER ATTENUATION BASIN MAINTENANCE ACCESS TRACK
- PROPOSED SURFACE WATER DRAINAGE OUTFALL
- PROPOSED RETAINING WALL
- PROPOSED VARIABLE MESSAGE SIGN
- PROPOSED GANTRY
- PROPOSED TRAFFIC SIGN(S) (ANCILLARY WORKS)
- PROPOSED EMERGENCY ROADSIDE TELEPHONE
- PROPOSED SPLITTER ISLAND

REV	DATE	REVISION NOTE	ORIG	CHKD	APPD
01	JUNE 2023	DEADLINE 2	EO	LC	MF
0	NOVEMBER 2022	APPLICATION SUBMISSION	GP	LC	MF

REFERENCE MAP

DESIGNER
Stantec

CONTRACTOR
VolkerFitzpatrick

CLIENT
national highways

PROJECT TITLE
M3 JUNCTION 9 IMPROVEMENT SCHEME

PROJECT STAGE
PCF STAGE 3

DRAWING TITLE
**WORKS PLANS
 APFP REGULATION 5(2)(j)
 SHEET 6 OF 10
 DOCUMENT REFERENCE: 2.3**

SUITABILITY
APPLICATION SUBMISSION

SHEET SIZE: A1 | SCALE: 1:1250 | STATUS: REV 01
 DRAWING NUMBER
 HES51511-VFK-LSI-X_XXXX_XX-DR-ZL-1006

© Crown copyright and database rights 2022. Use of this data is subject to terms and conditions. Ordnance Survey Licence 100030649

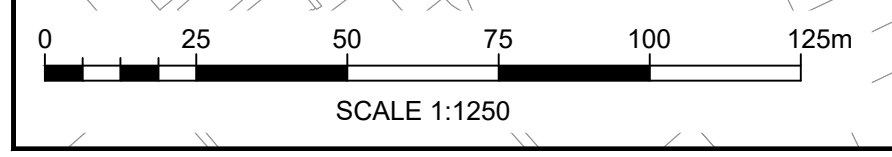
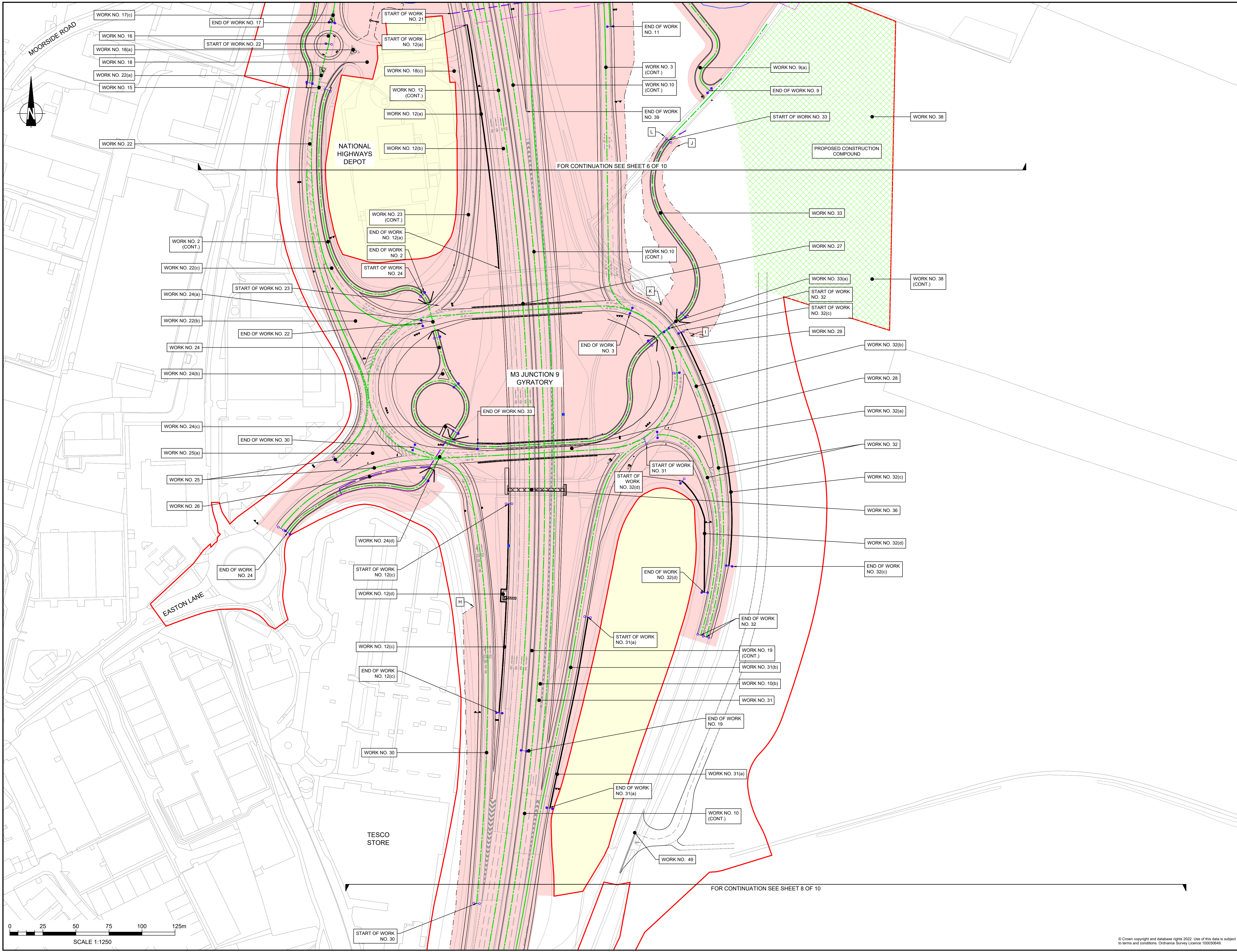

NOTES

Purpose of use
APPLICATION SUBMISSION
 Development Consent Order Number / Document
 TR010055/2.3

- THIS DRAWING HAS BEEN PRODUCED USING CAD SOFTWARE. THEREFORE ALL DIMENSIONS ARE SHOWN IN METRES UNLESS SHOWN OTHERWISE.
- DO NOT SCALE FROM THIS DRAWING. USE ONLY PRINTED DIMENSIONS.
- THE DESIGN SHOWN WILL BE SUBJECT TO DETAILED DESIGN DEVELOPMENT IN ACCORDANCE WITH THE PROVISIONS OF THE DEVELOPMENT CONSENT ORDER.

KEY TO SYMBOLS

- DEVELOPMENT CONSENT ORDER BOUNDARY
- LAND NOT INCLUDED IN ORDER LIMITS
- HIGHWAY WORK LIMIT OF DEVIATION (AS DETAILED IN PART 2 OF THE DEVELOPMENT CONSENT ORDER)
- LIMITS OF DEVIATION LABEL (AS DETAILED IN PART 2 OF THE DEVELOPMENT CONSENT ORDER)
- WORK NUMBER (AS DETAILED IN SCHEDULE 1 OF THE DEVELOPMENT CONSENT ORDER)
- COMMENCEMENT OF LINEAR WORKS
- TERMINATION OF LINEAR WORKS
- COMMENCEMENT AND TERMINATION OF LINEAR WORKS
- PROPOSED HIGHWAY WORK CENTRE LINE (APPROX)
- PROPOSED EARTHWORKS OUTLINE (INCLUDING LATERAL DEVIATION)
- PROPOSED ROAD MARKINGS
- PROPOSED CONSTRUCTION COMPOUND
- PROPOSED UTILITY DIVERSION CENTRELINE
- PROPOSED UTILITY DIVERSION LIMIT OF DEVIATION
- PROPOSED SURFACE WATER DRAINAGE DITCH
- PROPOSED SURFACE WATER ATTENUATION BASIN
- PROPOSED SURFACE WATER ATTENUATION BASIN
- MAINTENANCE ACCESS TRACK
- PROPOSED SURFACE WATER DRAINAGE OUTFALL
- PROPOSED RETAINING WALL
- PROPOSED VARIABLE MESSAGE SIGN
- PROPOSED GANTRY
- PROPOSED TRAFFIC SIGN(S) (ANCILLARY WORKS)
- PROPOSED EMERGENCY ROADSIDE TELEPHONE
- PROPOSED SPLITTER ISLAND

01	JUNE 2023	DEADLINE 2	EO	LC	MF
0	NOVEMBER 2022	APPLICATION SUBMISSION	GP	LC	MF
REV	DATE	REVISION NOTE	ORIG	CHKD	APPD

REFERENCE MAP

DESIGNER
Stantec

CONTRACTOR
VolkerFitzpatrick

CLIENT
national highways

PROJECT TITLE
M3 JUNCTION 9 IMPROVEMENT SCHEME

PROJECT STAGE
PCF STAGE 3

DRAWING TITLE
**WORKS PLANS
 APFP REGULATION 5(2)(j)
 SHEET 7 OF 10
 DOCUMENT REFERENCE: 2.3**

SUITABILITY
APPLICATION SUBMISSION

SHEET SIZE: A1 SCALE: 1:1250 STATUS: REV 01

DRAWING NUMBER
 HES51511-VFK-LSI-X_XXXX_XX-DR-ZL-1007

© Crown copyright and database rights 2022. Use of this data is subject to terms and conditions. Ordnance Survey Licence 100030649.

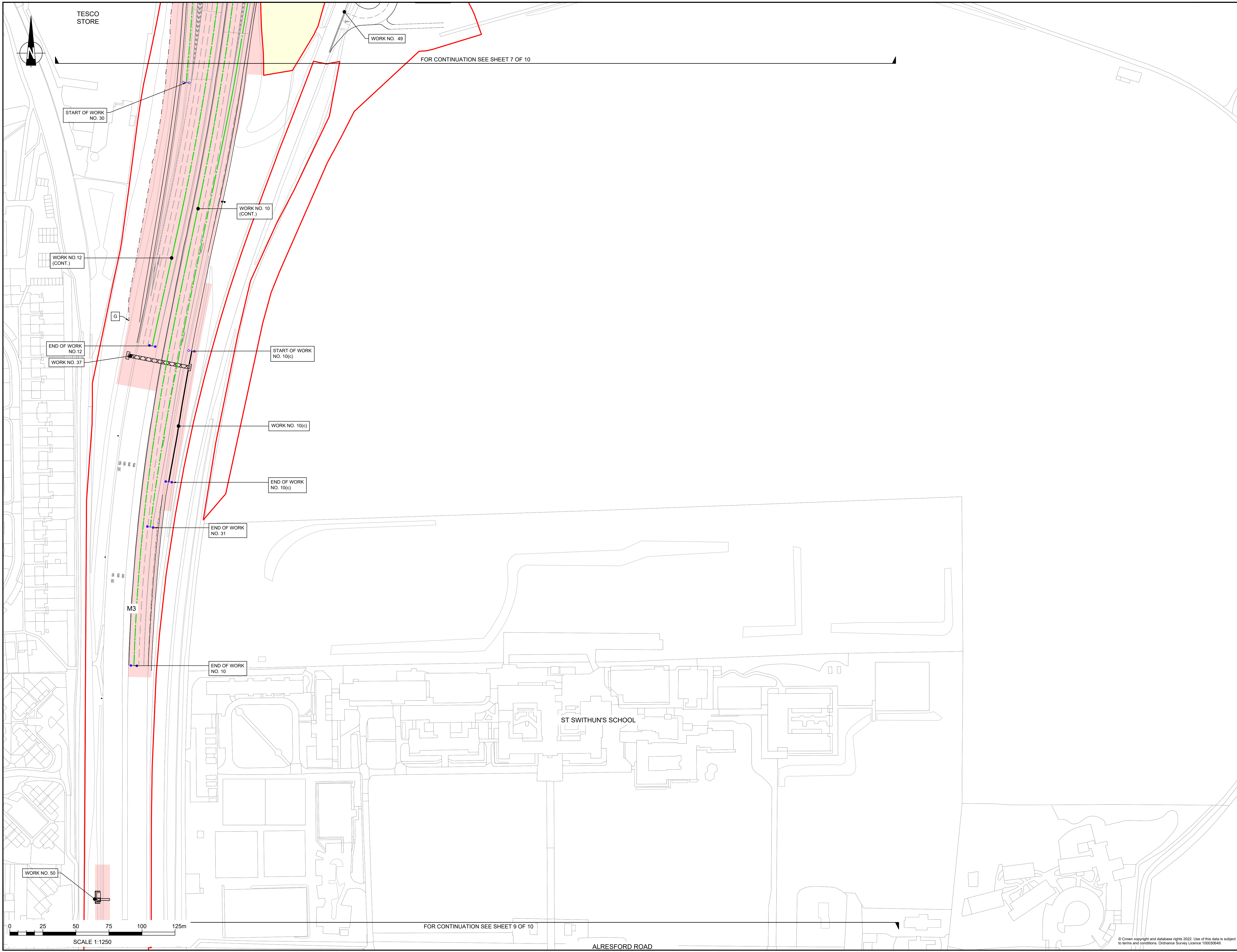

NOTES

Purpose of use
APPLICATION SUBMISSION

Development Consent Order Number / Document
TR010055/2.3

- THIS DRAWING HAS BEEN PRODUCED USING CAD SOFTWARE. THEREFORE ALL DIMENSIONS ARE SHOWN IN METRES UNLESS SHOWN OTHERWISE.
- DO NOT SCALE FROM THIS DRAWING. USE ONLY PRINTED DIMENSIONS.
- THE DESIGN SHOWN WILL BE SUBJECT TO DETAILED DESIGN DEVELOPMENT IN ACCORDANCE WITH THE PROVISIONS OF THE DEVELOPMENT CONSENT ORDER.

KEY TO SYMBOLS

- DEVELOPMENT CONSENT ORDER BOUNDARY
- LAND NOT INCLUDED IN ORDER LIMITS
- HIGHWAY WORK LIMIT OF DEVIATION (AS DETAILED IN PART 2 OF THE DEVELOPMENT CONSENT ORDER)
- LIMITS OF DEVIATION LABEL (AS DETAILED IN PART 2 OF THE DEVELOPMENT CONSENT ORDER)
- WORK NUMBER (AS DETAILED IN SCHEDULE 1 OF THE DEVELOPMENT CONSENT ORDER)
- COMMENCEMENT OF LINEAR WORKS
- TERMINATION OF LINEAR WORKS
- COMMENCEMENT AND TERMINATION OF LINEAR WORKS
- PROPOSED HIGHWAY WORK CENTRE LINE (APPROX)
- PROPOSED EARTHWORKS OUTLINE (INCLUDING LATERAL DEVIATION)
- PROPOSED ROAD MARKINGS
- PROPOSED CONSTRUCTION COMPOUND
- PROPOSED UTILITY DIVERSION CENTRELINE
- PROPOSED UTILITY DIVERSION LIMIT OF DEVIATION
- PROPOSED SURFACE WATER DRAINAGE DITCH
- PROPOSED SURFACE WATER ATTENUATION BASIN
- PROPOSED SURFACE WATER ATTENUATION BASIN
- MAINTENANCE ACCESS TRACK
- PROPOSED SURFACE WATER DRAINAGE OUTFALL
- PROPOSED RETAINING WALL
- PROPOSED VARIABLE MESSAGE SIGN
- PROPOSED GANTRY
- PROPOSED TRAFFIC SIGN(S) (ANCILLARY WORKS)
- PROPOSED EMERGENCY ROADSIDE TELEPHONE
- PROPOSED SPLITTER ISLAND

REV	DATE	REVISION NOTE	ORIG	CHKD	APPD
01	JUNE 2023	DEADLINE 2	EO	LC	MF
0	NOVEMBER 2022	APPLICATION SUBMISSION	GP	LC	MF

REFERENCE MAP

DESIGNER
Stantec

CONTRACTOR
VolkerFitzpatrick

CLIENT
national highways

PROJECT TITLE
M3 JUNCTION 9 IMPROVEMENT SCHEME

PROJECT STAGE
PCF STAGE 3

DRAWING TITLE
**WORKS PLANS
APFP REGULATION 5(2)(j)
SHEET 8 OF 10
DOCUMENT REFERENCE: 2.3**

SUITABILITY
APPLICATION SUBMISSION

SHEET SIZE: A1 | SCALE: 1:1250 | STATUS: REV 01

DRAWING NUMBER
HE551511-VFK-LSI-X_XXXX_XX-DR-ZL-1008

© Crown copyright and database rights 2022. Use of this data is subject to terms and conditions. Ordnance Survey Licence 100030649

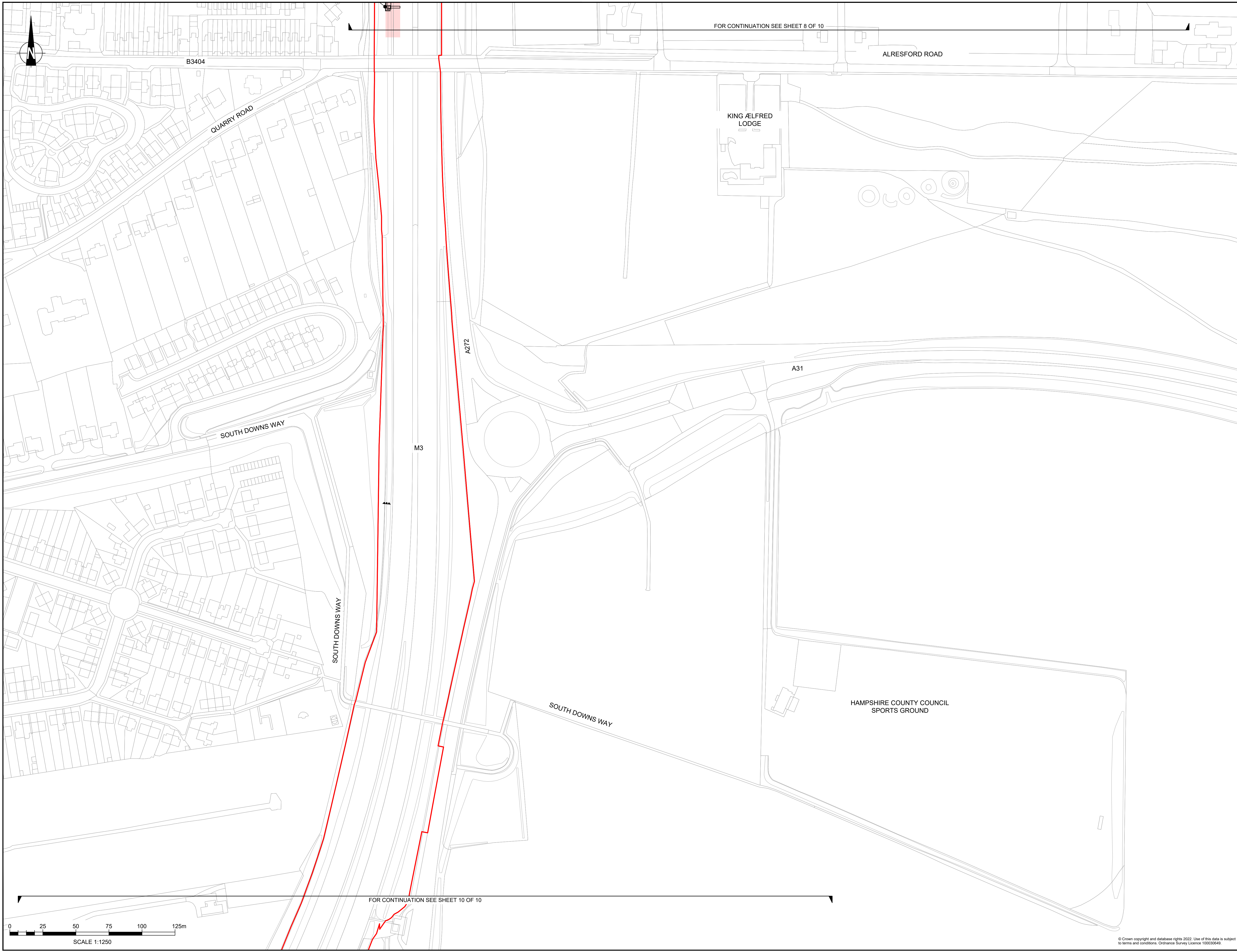

FOR CONTINUATION SEE SHEET 8 OF 10

FOR CONTINUATION SEE SHEET 10 OF 10

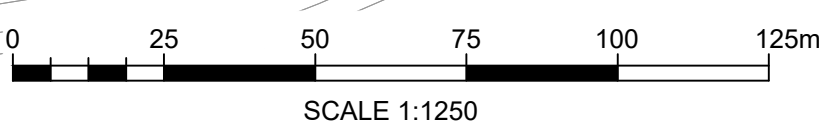

NOTES

Purpose of use
APPLICATION SUBMISSION
 Development Consent Order Number / Document
TR010055/2.3

- THIS DRAWING HAS BEEN PRODUCED USING CAD SOFTWARE. THEREFORE ALL DIMENSIONS ARE SHOWN IN METRES UNLESS SHOWN OTHERWISE.
- DO NOT SCALE FROM THIS DRAWING. USE ONLY PRINTED DIMENSIONS.
- THE DESIGN SHOWN WILL BE SUBJECT TO DETAILED DESIGN DEVELOPMENT IN ACCORDANCE WITH THE PROVISIONS OF THE DEVELOPMENT CONSENT ORDER.

KEY TO SYMBOLS

- DEVELOPMENT CONSENT ORDER BOUNDARY
- LAND NOT INCLUDED IN ORDER LIMITS
- HIGHWAY WORK LIMIT OF DEVIATION (AS DETAILED IN PART 2 OF THE DEVELOPMENT CONSENT ORDER)
- LIMITS OF DEVIATION LABEL (AS DETAILED IN PART 2 OF THE DEVELOPMENT CONSENT ORDER)
- WORK NUMBER (AS DETAILED IN SCHEDULE 1 OF THE DEVELOPMENT CONSENT ORDER)
- COMMENCEMENT OF LINEAR WORKS
- TERMINATION OF LINEAR WORKS
- COMMENCEMENT AND TERMINATION OF LINEAR WORKS
- PROPOSED HIGHWAY WORK CENTRE LINE (APPROX)
- PROPOSED EARTHWORKS OUTLINE (INCLUDING LATERAL DEVIATION)
- PROPOSED ROAD MARKINGS
- PROPOSED CONSTRUCTION COMPOUND
- PROPOSED UTILITY DIVERSION CENTRELINE
- PROPOSED UTILITY DIVERSION LIMIT OF DEVIATION
- PROPOSED SURFACE WATER DRAINAGE DITCH
- PROPOSED SURFACE WATER ATTENUATION BASIN
- PROPOSED SURFACE WATER ATTENUATION BASIN
- MAINTENANCE ACCESS TRACK
- PROPOSED SURFACE WATER DRAINAGE OUTFALL
- PROPOSED RETAINING WALL
- PROPOSED VARIABLE MESSAGE SIGN
- PROPOSED GANTRY
- PROPOSED TRAFFIC SIGN(S) (ANCILLARY WORKS)
- PROPOSED EMERGENCY ROADSIDE TELEPHONE
- PROPOSED SPLITTER ISLAND

REV	DATE	REVISION NOTE	ORIG	CHKD	APPD
01	JUNE 2023	DEADLINE 2	EO	LC	MF
0	NOVEMBER 2022	APPLICATION SUBMISSION	GP	LC	MF

REFERENCE MAP

DESIGNER

CONTRACTOR

CLIENT

PROJECT TITLE
M3 JUNCTION 9 IMPROVEMENT SCHEME

PROJECT STAGE
PCF STAGE 3

DRAWING TITLE
**WORKS PLANS
 APFP REGULATION 5(2)(j)
 SHEET 9 OF 10
 DOCUMENT REFERENCE: 2.3**

SUITABILITY
APPLICATION SUBMISSION

SHEET SIZE: A1 | SCALE: 1:1250 | STATUS: REV 01
 DRAWING NUMBER
 HES51511-VFK-LSI-X_XXXX_XX-DR-ZL-1009

© Crown copyright and database rights 2022. Use of this data is subject to terms and conditions. Ordnance Survey Licence 100030649.

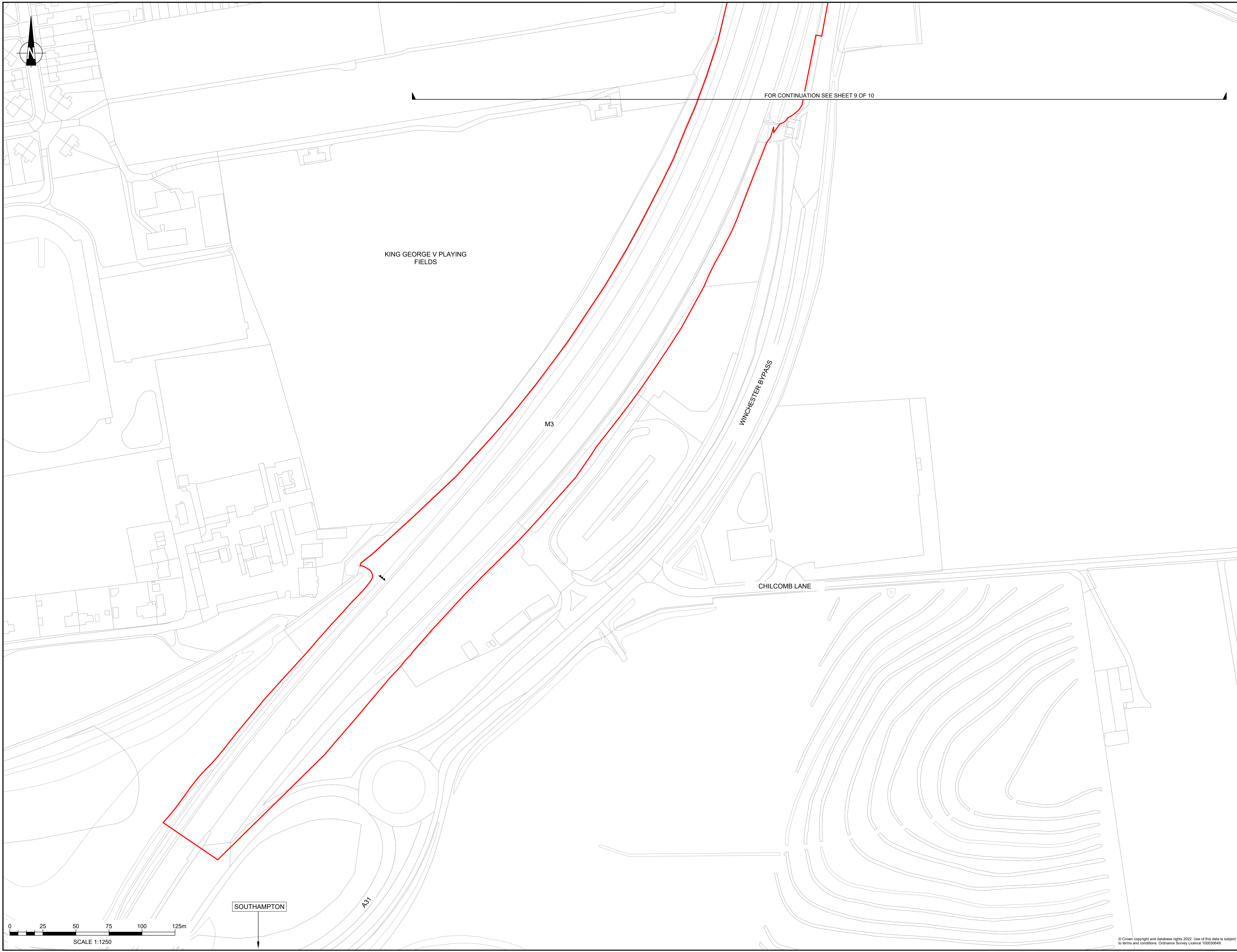

FOR CONTINUATION SEE SHEET 9 OF 10

KING GEORGE V PLAYING FIELDS

WINCHESTER BYPASS

CHILCOMB LANE

M3

SOUTHAMPTON

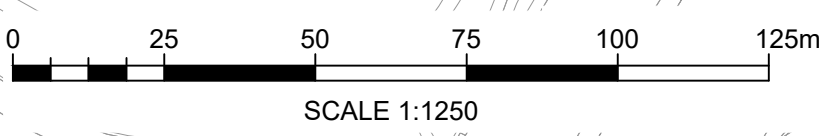

NOTES

Purpose of use
APPLICATION SUBMISSION
 Development Consent Order Number / Document
 TR010055/2.3

- THIS DRAWING HAS BEEN PRODUCED USING CAD SOFTWARE. THEREFORE ALL DIMENSIONS ARE SHOWN IN METRES UNLESS SHOWN OTHERWISE.
- DO NOT SCALE FROM THIS DRAWING. USE ONLY PRINTED DIMENSIONS.
- THE DESIGN SHOWN WILL BE SUBJECT TO DETAILED DESIGN DEVELOPMENT IN ACCORDANCE WITH THE PROVISIONS OF THE DEVELOPMENT CONSENT ORDER.

KEY TO SYMBOLS

- DEVELOPMENT CONSENT ORDER BOUNDARY
- LAND NOT INCLUDED IN ORDER LIMITS
- HIGHWAY WORK LIMIT OF DEVIATION (AS DETAILED IN PART 2 OF THE DEVELOPMENT CONSENT ORDER)
- LIMITS OF DEVIATION LABEL (AS DETAILED IN PART 2 OF THE DEVELOPMENT CONSENT ORDER)
- WORK NUMBER (AS DETAILED IN SCHEDULE 1 OF THE DEVELOPMENT CONSENT ORDER)
- COMMENCEMENT OF LINEAR WORKS
- TERMINATION OF LINEAR WORKS
- COMMENCEMENT AND TERMINATION OF LINEAR WORKS
- PROPOSED HIGHWAY WORK CENTRE LINE (APPROX)
- PROPOSED EARTHWORKS OUTLINE (INCLUDING LATERAL DEVIATION)
- PROPOSED ROAD MARKINGS
- PROPOSED CONSTRUCTION COMPOUND
- PROPOSED UTILITY DIVERSION CENTRELINE
- PROPOSED UTILITY DIVERSION LIMIT OF DEVIATION
- PROPOSED SURFACE WATER DRAINAGE DITCH
- PROPOSED SURFACE WATER ATTENUATION BASIN
- PROPOSED SURFACE WATER ATTENUATION BASIN MAINTENANCE ACCESS TRACK
- PROPOSED SURFACE WATER DRAINAGE OUTFALL
- PROPOSED RETAINING WALL
- PROPOSED VARIABLE MESSAGE SIGN
- PROPOSED GANTRY
- PROPOSED TRAFFIC SIGN(S) (ANCILLARY WORKS)
- PROPOSED EMERGENCY ROADSIDE TELEPHONE
- PROPOSED SPLITTER ISLAND

REV	DATE	REVISION NOTE	ORIG	CHKD	APPD
01	JUNE 2023	DEADLINE 2	EO	LC	MF
0	NOVEMBER 2022	APPLICATION SUBMISSION	GP	LC	MF

REFERENCE MAP

DESIGNER
Stantec

CONTRACTOR
VolkerFitzpatrick

CLIENT
national highways

PROJECT TITLE
 M3 JUNCTION 9 IMPROVEMENT SCHEME

PROJECT STAGE
 PCF STAGE 3

DRAWING TITLE
 WORKS PLANS
 APFP REGULATION 5(2)(j)
 SHEET 10 OF 10
 DOCUMENT REFERENCE: 2.3

SUITABILITY
 APPLICATION SUBMISSION

SHEET SIZE: A1 | SCALE: 1:1250 | STATUS: REV 01
 DRAWING NUMBER
 HES51511-VFK-LSI-X_XXXX_XX-DR-ZL-1010

© Crown copyright and database rights 2022. Use of this data is subject to terms and conditions. Ordnance Survey Licence 100030649.